

**739 LMOB
MALE ADAPTER**

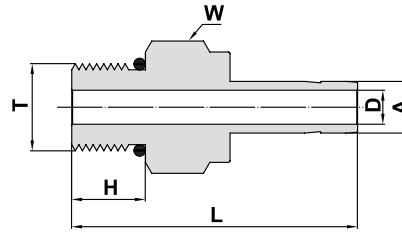

TUBE (INCH) TO SAE/MS STRAIGHT THREAD BOSS***

Ordering Information	A Tube O.D.		T Straight Thread UN	D		W		H		L		O-Ring**
	inch	mm	inch	inch	mm	inch	mm	inch	mm	inch	mm	
739LMOB_ 1/8 X 5/16-24	1/8	3.18	5/16-24	.08	2.03	7/16	11.1	.30	7.62	1.20	30.48	-902
739LMOB_ 1/4 X 7/16-20	1/4	6.35	7/16-20	.17	4.20	9/16	14.3	.36	9.14	1.39	35.3	-904
739LMOB_ 1/4 X 9/16-18	1/4	6.35	9/16-18	.17	4.20	11/16	17.5	.39	9.90	1.42	36.07	-906
739LMOB_ 3/8 X 7/16-20	3/8	9.52	7/16-20	.20	5.10	9/16	14.3	.36	9.14	1.46	37.08	-904
739LMOB_ 3/8 X 9/16-18	3/8	9.52	9/16-18	.27	6.85	11/16	17.5	.39	9.90	1.52	38.61	-906
739LMOB_ 3/8 X 3/4-16	3/8	9.52	3/4-16	.27	6.85	7/8	22.2	.44	11.17	1.60	40.64	-908
739LMOB_ 1/2 X 9/16-18	1/2	12.7	9/16-18	.28	7.11	11/16	17.5	.39	9.90	1.74	44.20	-906
739LMOB_ 1/2 X 3/4-16	1/2	12.7	3/4-16	.37	9.40	7/8	22.2	.44	11.17	1.82	46.23	-908
739LMOB_ 5/8 X 7/8-14	5/8	15.87	7/8-14	.47	11.94	1	25.4	.50	12.70	1.94	49.28	-910
739LMOB_ 3/4 X 1 1/16-12	3/4	19.05	1 1/16-12	.59	15.00	1 1/4	31.8	.59	14.98	2.10	53.34	-912
739LMOB_ 1 X 1 5/16-12	1	25.40	1 5/16-12	.80	20.32	1 1/2	38.1	.59	14.98	2.41	61.21	-916
739LMOB_ 1 1/4 X 1 5/8-12	* 1 1/4	31.75	1 5/8-12	1.02	26.00	1 7/8	47.6	.59	15.10	2.81	71.37	-920
739LMOB_ 1 1/2 X 1 7/8-12	*1 1/2	38.10	1 7/8-12	1.25	31.60	2 1/8	54.0	.59	15.10	3.28	83.31	-924

Designation: Marking LOB on Hex.

*** Per SAE J1926 and MS 16142. See page 80 for mounting dimensions.

** O-rings used are Fluorocarbon FKM 90 Durometer. Other O-ring materials are available on request.

* Supplied assembled with Nut + Front and Back Ferrule. Including low friction paste, see page 91.

"D" - Dimension is minimum opening. Dimensions are for reference only, and are subject to change without notice.